

S Type Clamp

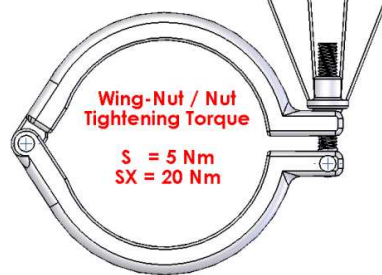

SH Type Clamp

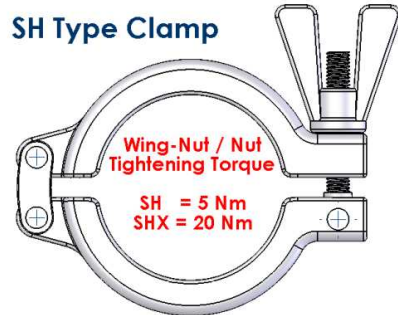

SSH Type Clamp

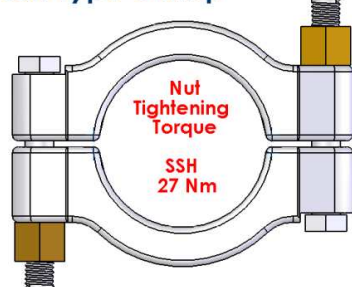

ASME VIII Clamp

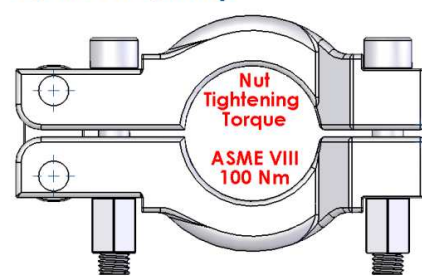

CLAMP SIZE		PRESSURE RATINGS (bar)							
Nominal Size	Metric Size	Max Working Pressure @ 150C				Max Test Pressure			
		S	SH	SSH	ASME VIII	S	SH	SSH	ASME VIII
1/2"-3/4"	-	25	50	75	-	50	100	150	-
-	DN 10-20	25	50	-	-	50	100	-	-
1"-1 1/2"	DN 25-40	25	50	75	-	50	100	150	-
2"	50	25	50	75	90	50	100	150	450
2 1/2"	-	25	50	75	-	50	100	150	-
3"	65	20	40	60	-	40	80	120	-
3 1/2"	80	20	40	60	-	40	80	120	-
4"	100	17	35	53	57	34	70	105	285
4 1/2"	-	15	30	45	-	30	60	90	-
5"	-	-	30	-	-	-	60	-	-
5 1/2"	125	-	30	-	-	-	60	-	-
6"	-	-	30	45	28	-	60	90	140
6 5/8"	150	-	25	38	22	-	50	75	110
8"	-	-	20	-	15	-	40	-	75
8 5/8"	200	-	20	30	-	-	40	60	-
10"	250	-	16	-	10	-	32	-	50
10 5/8"	-	-	16	24	-	-	32	48	-
12"	300	-	10	-	7	-	20	-	35
12 5/8"	-	-	10	15	-	-	20	30	-

- # SH Clamp working pressure ratings are permanently cast on the outside of the clamps as a PN rating.
- # ASME VIII Clamp pressure ratings are calculated under the strict guidelines as given by the ASME VIII Code and incorporate a safe working factor of 5.

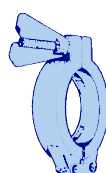

PHARMACEUTICAL CLAMPS S-TYPE

Material	304 / 1.4301
Application	Light Duty
Hinge Lay-Out	Single Interlocking Rivet

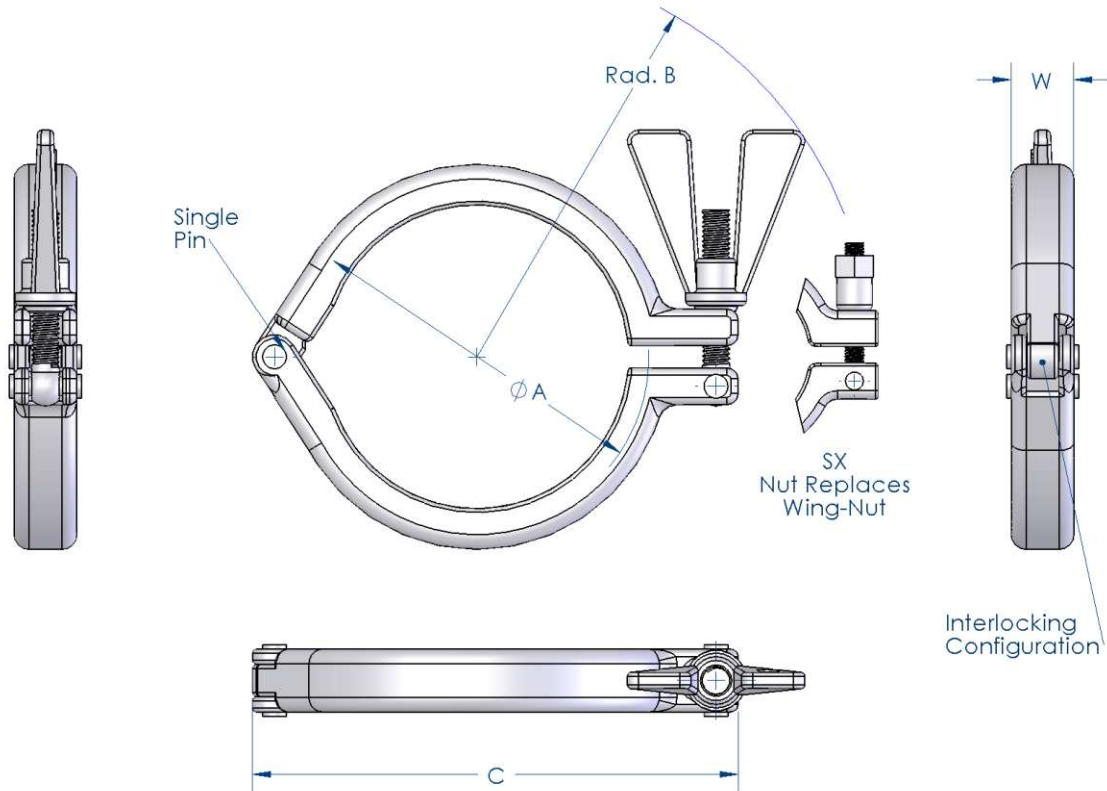

S TYPE CLAMP

Nominal Clamp Size	Dimension (mm)				Mass (kg)	Ordering Codes S	Ordering Codes SX
	Flange ØA	Rad. B	Length C	Width W			
1/2"-3/4"	25.4	63.0	60.0	17.0	0.13	CL.S.0050	CL.SX.0050
DIN 10/15/20	34.0	73.0	69.0	17.0	0.17	CL.S.D010	CL.SX.D010
1"-1 1/2"	50.5	78.0	85.0	17.0	0.21	CL.S.0100	CL.SX.0100
2"	64.0	82.0	99.0	17.0	0.25	CL.S.0200	CL.SX.0200
2 1/2"	77.5	89.0	112.0	17.0	0.35	CL.S.0250	CL.SX.0250
3"	91.0	96.0	126.0	17.0	0.42	CL.S.0300	CL.SX.0300
3 1/2"	106.0	103.0	140.0	17.0	0.44	CL.S.0350	CL.SX.0350
4"	119.0	110.0	154.0	17.0	0.51	CL.S.0400	CL.SX.0400
4 1/2"	130.0	115.0	165.0	17.0	0.60	CL.S.0450	CL.SX.0450
6"	167.0	134.0	216.0	25.0	0.88	CL.S.0600	CL.SX.0600

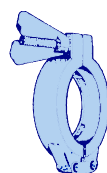

Material	304 1.4301
Application	Normal / Heavy Duty
Hinge Lay-Out	Double Rivet Hinge Plate

PHARMACEUTICAL CLAMPS SH-TYPE - SINGLE BOLT

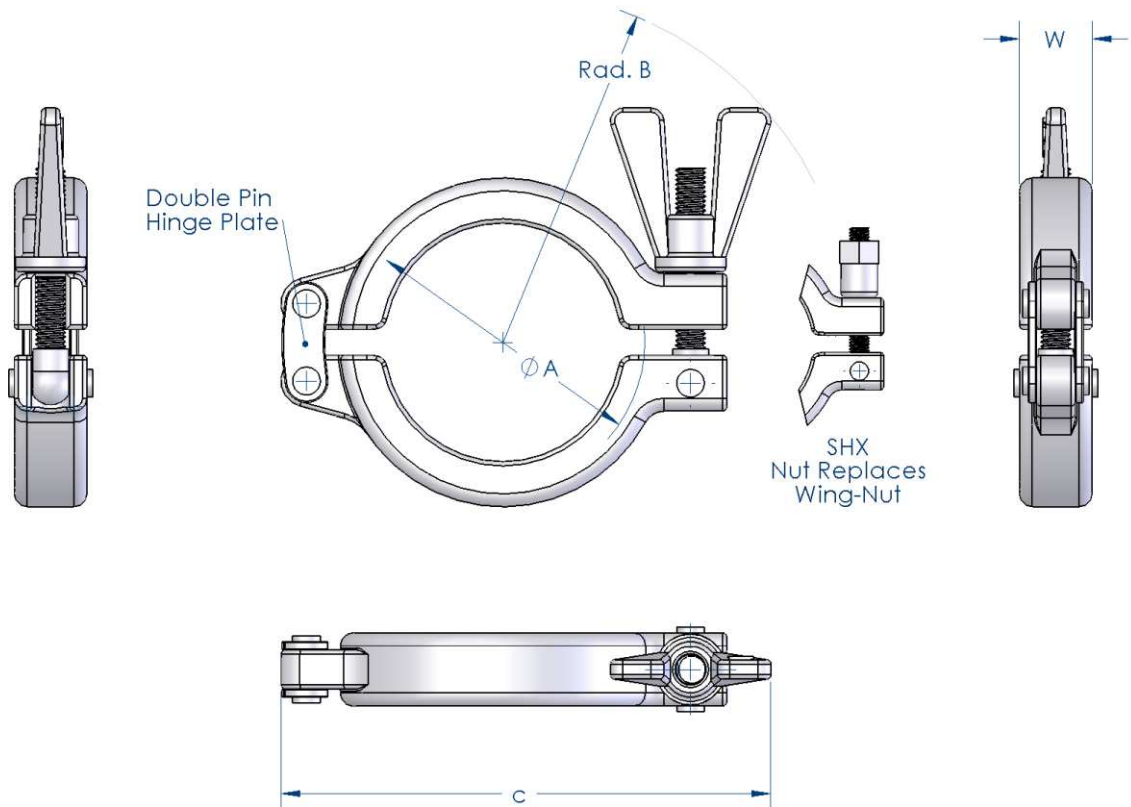

SH TYPE CLAMP - SINGLE BOLT

Nominal Clamp Size	Dimension (mm)				Mass (Kg)	Ordering Codes SH	Ordering Codes SHX
	Flange ØA	Rad. B	Length C	Width W			
1/2"-3/4"	25.4	63.0	75.0	17.0	0.15	CL.SH.0050	CL.SHX.0050
1"-1 1/2"	50.5	77.0	102.0	17.0	0.25	CL.SH.0100	CL.SHX.0100
2"	64.0	93.0	123.0	17.0	0.33	CL.SH.0200	CL.SHX.0200
2 1/2"	77.5	100.0	140.0	17.0	0.38	CL.SH.0250	CL.SHX.0250
3"	91.0	105.0	150.0	17.0	0.44	CL.SH.0300	CL.SHX.0300
3 1/2"	106.0	110.0	165.0	17.0	0.44	CL.SH.0350	CL.SHX.0350
4"	119.0	119.0	185.0	17.0	0.57	CL.SH.0400	CL.SHX.0400
4 1/2"	130.0	119.0	191.0	17.0	0.60	CL.SH.0450	CL.SHX.0450
5"	144.0	131.0	215.0	19.0	0.75	CL.SH.0500	CL.SHX.0500
5 1/2"	155.0	155.0	252.0	24.0	1.39	CL.SH.0550	CL.SHX.0550
6"	167.0	156.0	262.0	24.0	1.38	CL.SH.0600	CL.SHX.0600
6 5/8"	183.0	164.0	280.0	24.0	1.61	CL.SH.0658	CL.SHX.0658
8"	217.0	184.0	325.0	24.0	2.11	CL.SH.0800	CL.SHX.0800
8 5/8"	233.0	185.0	333.0	24.0	2.25	CL.SH.0858	CL.SHX.0858

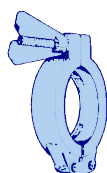

PHARMACEUTICAL CLAMPS

SH-TYPE CLAMP - DOUBLE BOLT

Material	304 1.4301
Application	Normal / Heavy Duty
Hinge Lay-Out	Length Adjustable Eyebolt

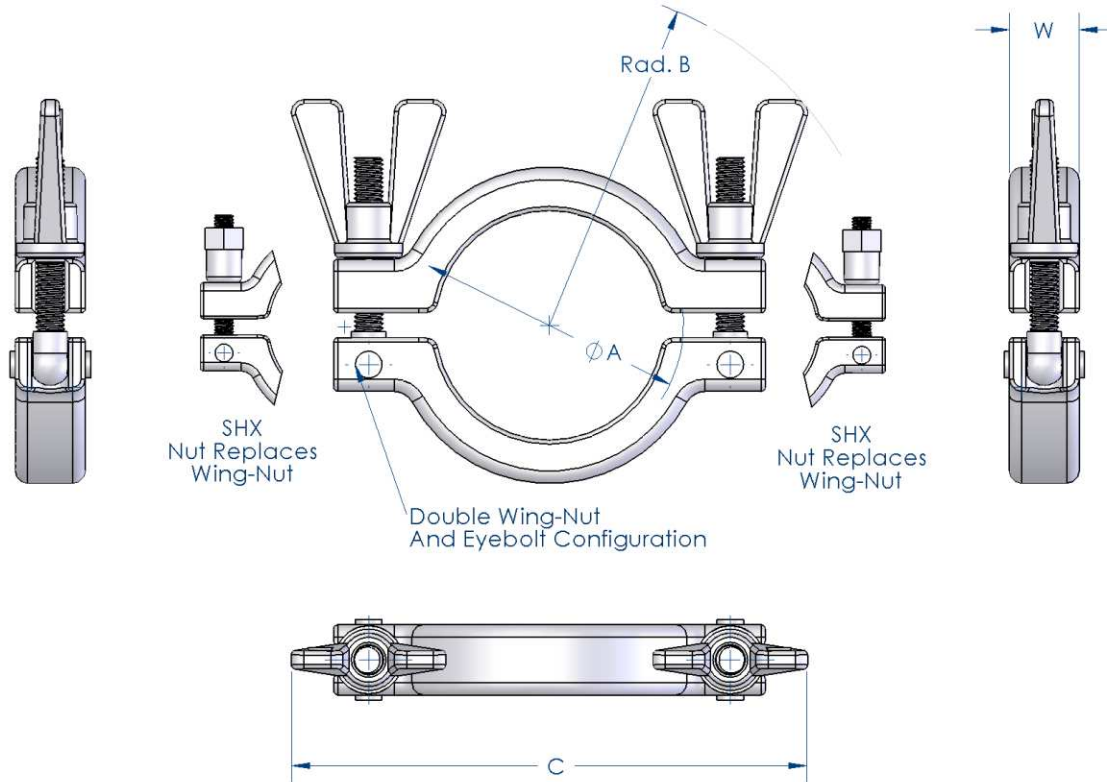

SH TYPE CLAMP - DOUBLE BOLT

Nominal Clamp Size	Dimension (mm)				Mass (Kg)	Ordering Codes SH	Ordering Codes SHX
	Flange ØA	Rad. B	Length C	Width W			
5 1/2"	155.0	155.0	265.0	24.0	1.47	CL.SHD.0550	CL.SHDX.0550
6"	167.0	156.0	277.0	24.0	1.67	CL.SHD.0600	CL.SHDX.0600
6 5/8"	183.0	164.0	297.0	24.0	1.69	CL.SHD.0658	CL.SHDX.0658
8"	217.0	184.0	332.0	24.0	2.19	CL.SHD.0800	CL.SHDX.0800
8 5/8"	233.0	185.0	353.0	24.0	2.34	CL.SHD.0858	CL.SHDX.0858
10"	268.0	205.0	382.0	24.0	2.78	CL.SHD.1000	CL.SHDX.1000
10 5/8"	286.0	213.0	405.0	24.0	2.97	CL.SHD.1058	CL.SHDX.1058
12"	319.0	242.0	458.0	24.0	3.69	CL.SHD.1200	CL.SHDX.1200
12 5/8"	338.0	243.0	463.0	24.0	3.37	CL.SHD.1258	CL.SHDX.1258

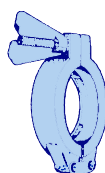

Material	304 1.4301
Application	Normal / Heavy Duty
Hinge Lay-Out	Double Rivet Hinge Plate

PHARMACEUTICAL CLAMPS

SH-TYPE - METRIC SIZES

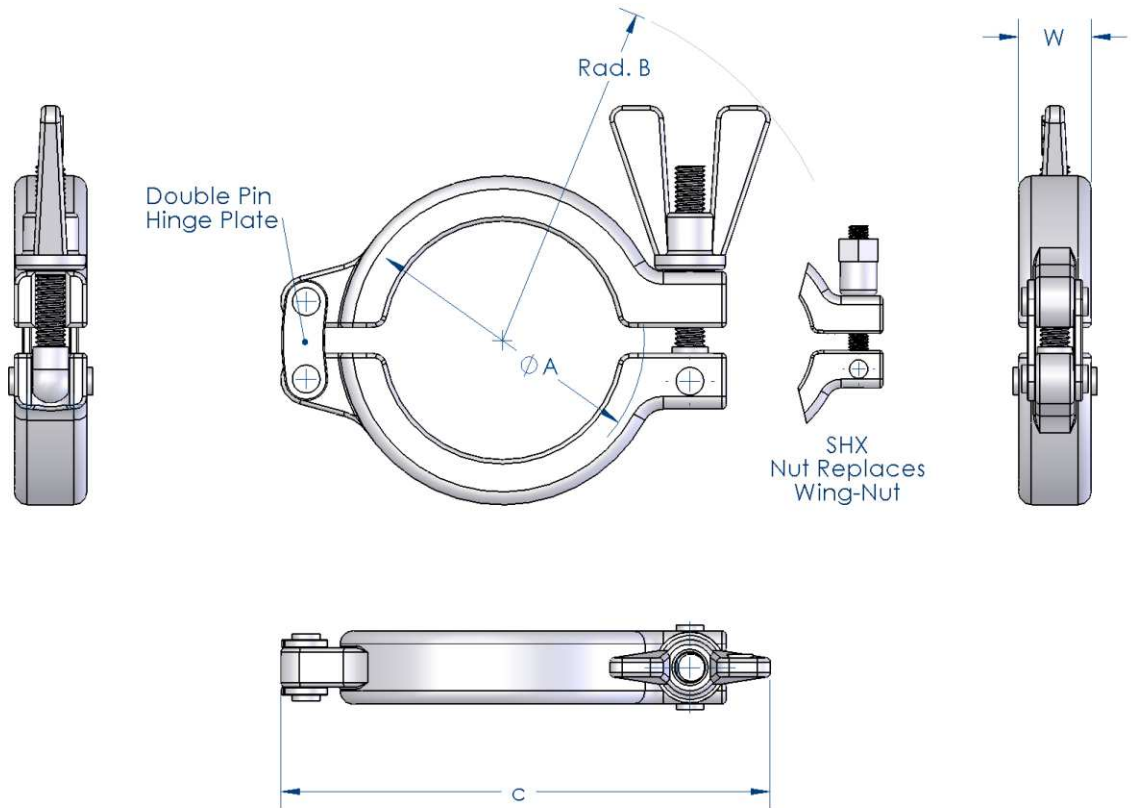

SH TYPE CLAMP - METRIC

Metric Clamp Size	Dimension (mm)				Mass (Kg)	Ordering Codes SH	Ordering Codes SHX
	Flange ØA	Rad. B	Length C	Width W			
10/15/20	34.0	67.0	85.0	17.0	0.17	CL.SH.D010	CL.SHX.D010
25	50.5	88.0	109.0	17.0	0.22	CL.SH.D025	CL.SHX.D025
50	64.0	93.0	123.0	17.0	0.28	CL.SH.D050	CL.SHX.D050
65	91.0	105.0	150.0	17.0	0.44	CL.SH.0300	CL.SHX.0300
80	106.0	110.0	165.0	17.0	0.44	CL.SH.0350	CL.SHX.0350
100	119.0	119.0	185.0	17.0	0.57	CL.SH.0400	CL.SHX.0400
125	155.0	155.0	252.0	24.0	1.39	CH.SH.0550	CH.SHX.0550
150	183.0	164.0	280.0	24.0	1.61	CL.SH.0658	CL.SHX.0658
200	233.0	185.0	333.0	24.0	2.25	CL.SH.0858	CL.SHX.0858
250*	268.0	213.0	382.0	24.0	2.78	CL.SH.1000	CL.SHX.1000
300*	319.0	242.0	458.0	24.0	3.69	CL.SH.1200	CL.SHX.1200

* = Double Bolt Only

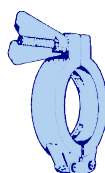

PHARMACEUTICAL CLAMPS SSH-TYPE

Material	304 1.4301
Application	Heavy Duty
Hinge Lay-Out	Separate Segments

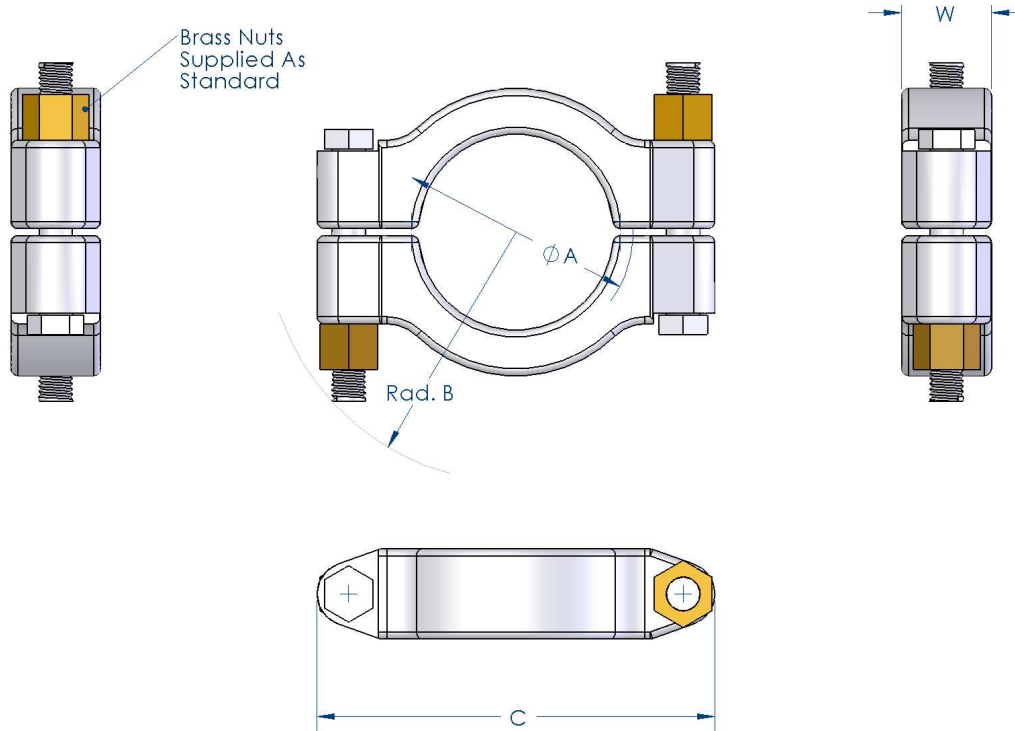

SSH TYPE CLAMP

Nominal Clamp Size	Dimension (mm)				Mass (Kg)	Ordering Codes SSH 304 Mat'l	Ordering Codes SSH 316 Mat'l
	Flange ϕA	Rad. B	Length C	Width W			
1/2" - 3/4"	25.4	34.0	65.0	16.0	0.16	CL.SSH.0050.4	CL.SSH.0050.6
DN 10/15/20	34.0	39.0	74.0	18.0	0.22	CL.SSH.D010.4	CL.SSH.D010.6
1"-1 1/2"	50.5	60.0	103.0	26.0	0.66	CL.SSH.0100.4	CL.SSH.0100.6
2"	64.0	67.0	113.0	26.0	0.82	CL.SSH.0200.4	CL.SSH.0200.6
2 1/2"	77.5	75.0	128.0	26.0	0.94	CL.SSH.0250.4	CL.SSH.0250.6
3"	91.0	80.0	137.0	26.0	1.02	CL.SSH.0300.4	CL.SSH.0300.6
3 1/2"	106.0	88.0	150.0	26.0	1.07	CL.SSH.0350.4	CL.SSH.0350.6
4"	119.0	93.0	165.0	26.0	1.27	CL.SSH.0400.4	CL.SSH.0400.6
4 1/2"	130.0	97.0	174.0	26.0	1.33	CL.SSH.0450.4	CL.SSH.0450.6
6"	167.0	132.0	240.0	26.0	1.93	CL.SSH.0600.4	CL.SSH.0600.6
6 5/8"	183.0	142.0	260.0	26.0	2.11	CL.SSH.0658.4	CL.SSH.0658.6
8 5/8"	233.0	168.0	318.0	26.0	2.52	CL.SSH.0858.4	CL.SSH.0858.6

Stainless Steel Nuts Can Be Supplied As Direct Replacements To The Standard Brass Nuts



Material	304 1.4301
Application	Pressure Vessel
Hinge Lay-Out	Hinge Plate & Safety Bolt

PHARMACEUTICAL CLAMPS ASME VIII PRESSURE VESSEL

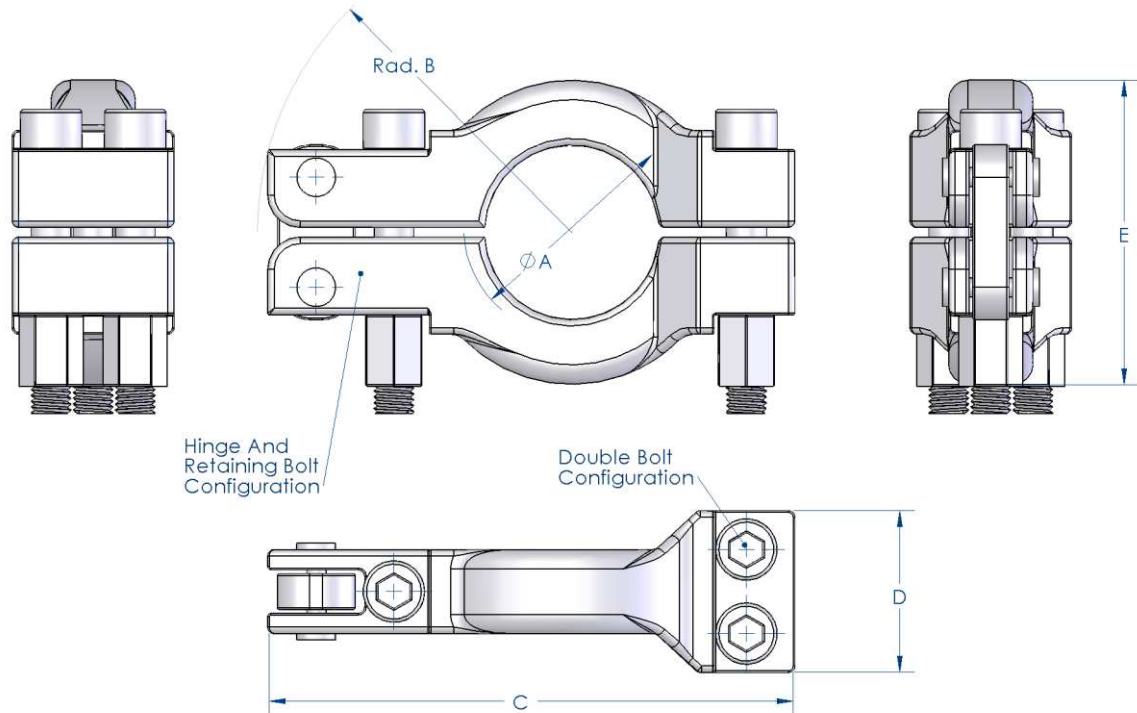

ASME VIII CLAMPS							
Nominal Clamp Sized	Dimensions (mm)					Mass (Kg)	Ordering Codes ASME VIII
	Flange $\varnothing A$	Rad B	Length C	Length D	Length E		
1" - 1 1/2"	50.5	85.0	145.0	50.0	80.0	1.80	CLAS8.0100
2"	64.0	97.0	163.0	50.0	94.0	1.96	CLAS8.0200
3"	91.0	115.0	203.0	50.0	124.0	3.20	CLAS8.0300
4"	119.0	135.0	233.0	50.0	160.0	3.68	CLAS8.0400
6"	167.0	160.0	281.0	50.0	206.0	4.70	CLAS8.0600
6 5/8"	183.0	170.0	300.0	50.0	222.0	4.98	CLAS8.0658
8"	217.0	185.0	333.0	50.0	258.0	5.45	CLAS8.0800
10"	268.0	210.0	385.0	50.0	308.0	6.30	CLAS8.1000
12"	319.0	235.0	433.0	50.0	358.0	7.02	CLAS8.1200

