



FILTRO DIRITTO A 180°

180° FILTER

FILTRE DROIT 180°

DURCHGANGSSIEB 180°



Art. 96A

Filtro a 180° a saldare

180° filter - welding connections

Filtre droit a souder

Durchgangssieb 180° zum anschweiss

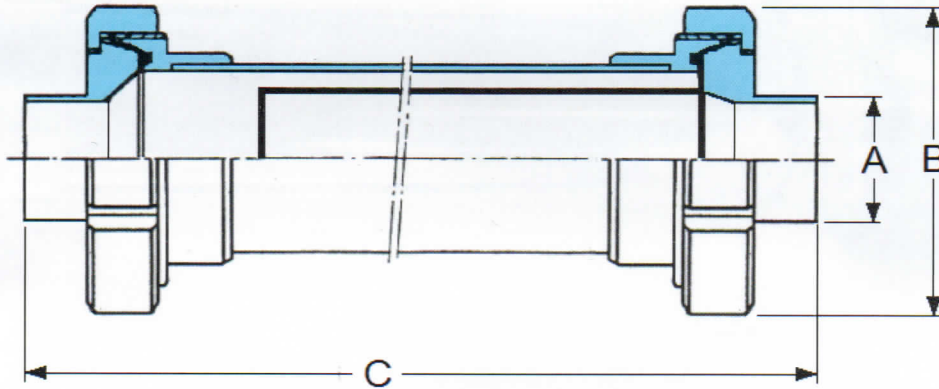

DN	1"	25	32	1½"	40	2"	50
A	25,4	28	34	38,1	40	50,8	52
B	112	112	112	112	112	112	112
C	361	361	361	361	361	361	361

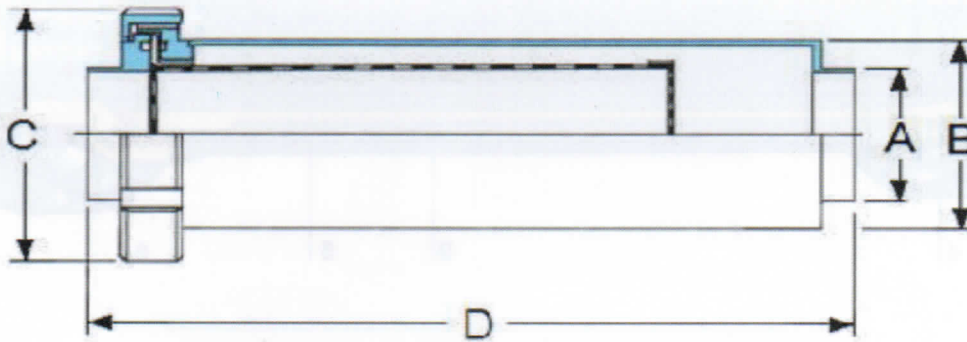

DN	60	2½"	65	3"	80	4"	100
A	60,3	63,5	70	76,2	85	101,6	104
B	114,3	114,3	114,3	114,3	129	129	129
C	148	148	148	148	178	178	178
D	372	372	372	372	470	470	470

range di temp. Std, std range of temperature, temperature d'exercice std, std betriebstemperatur	-10° + 100°
finitura std, std finishing, finissage std, std zurichten	Lucida est.- Satinata int. (Ra < 1,6 μ)
Filtraggio - Filtering - Filtration - Filtern	0,05 ÷ 10 mm